

Quick Installation Guide

I-SWHUB IND-143

Industrial Media Converter

Introduction

I-SWHUB IND-143 is an industrial media converter provide media conversion between 10/100Base-T(X) and 100Base-FX. I-SWHUB IND-143 is rigid IP-30 housing design and supporting wide operating temperature of -40 to 70°C. Therefore, the I-SWHUB IND-143 is a reliable media converter and can satisfy most demand of operating environment.



Features

- > Supports 2 ports 10/100Base-T(X) auto-negotiation and auto-MDI/MDI-X
- > 2x10/100Base-T(X) ports to save the usage of copper ports
- > High reliability and rigid IP-30 housing
- > DIN-Rail and wall-mountable

Connections of Media converter

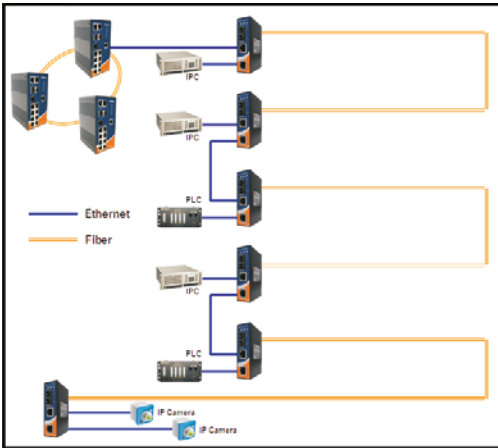
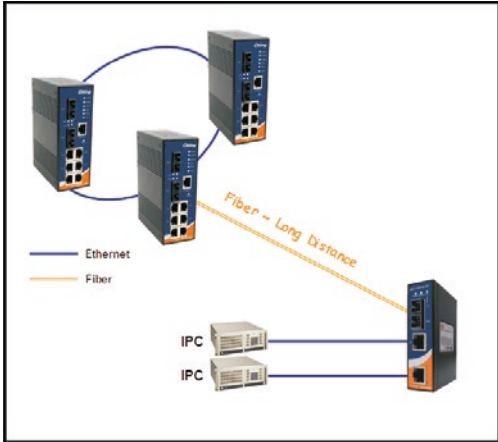

Specifications

Physical Ports	
10/100 Base-T(X) Ports in RJ45 Auto MDI/MDIX	2
100Base-FX Multi-mode Port (2Km, 1310nm, SC connector)	1
Technology	
Ethernet Standards	IEEE 802.3 for 10Base-T, IEEE 802.3u for 100Base-T(X) and 100Base-FX
LED Indicators	
Power Indicator	Green: Power LED x2
10/100Base-T(X) RJ 45 Port Indicator	Green for port Link/Act. Amber for Duplex/Collision
100Base-FX Fiber Port Indicator	Green for fiber port Link/Act
Power	
Input Power	Dual 12~48 VDC power inputs on 4-pin terminal block
Power Consumption(Typ.)	4.5 Watts
Overload Current Protection	Present
Reverse Polarity Protection	Present on terminal block
Physical Characteristic	
Enclosure	IP-30
Dimension (W x D x H)	26.1 (W) x 70 (D) x 95 (H)mm (1.03 x 2.76 x 3.74 inch)
Weight (g)	210 g
Environmental	
Storage Temperature	-40 to 85°C (-40 to 185°F)
Operating Temperature	-40 to 70°C (-40 to 158°F)
Operating Humidity	5% to 95% Non-condensing
Regulatory Approvals	
EMI	FCC Part 15, CISPR (EN55022) class A
EMS	EN61000-4-2 (ESD), EN61000-4-3 (RS), EN61000-4-4 (EFT), EN61000-4-5 (Surge), EN61000-4-6 (CS), EN61000-4-8, EN61000-4-11
Shock	IEC60068-2-27
Free Fall	IEC60068-2-32
Vibration	IEC60068-2-6
Safety	EN60950-1
Warranty	
	5 years

Installation

Din-Rail Install Step

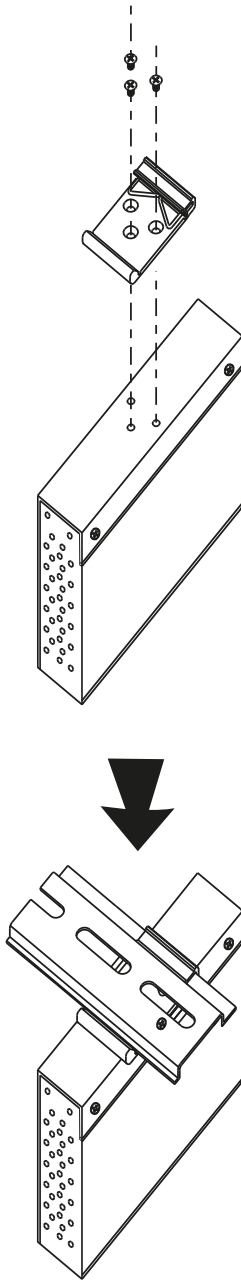

Wall-mounted Install Step

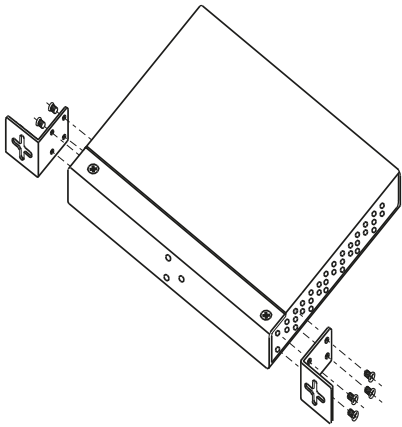

Quick Installation Guide

I-SWHUB IND-143

Industrial Media Converter

Front Panel

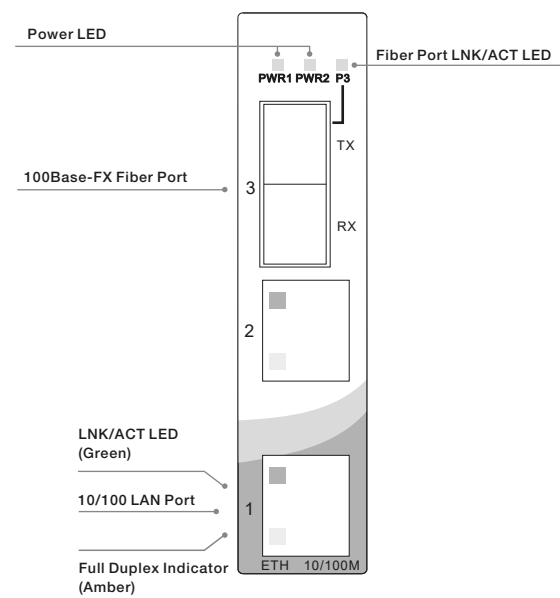

Power Connection Guide

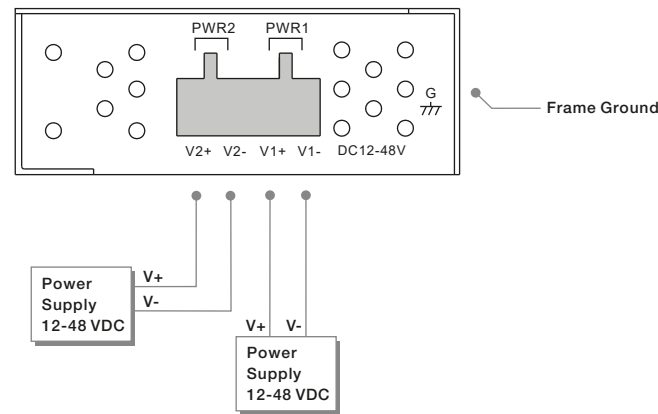

Accessory

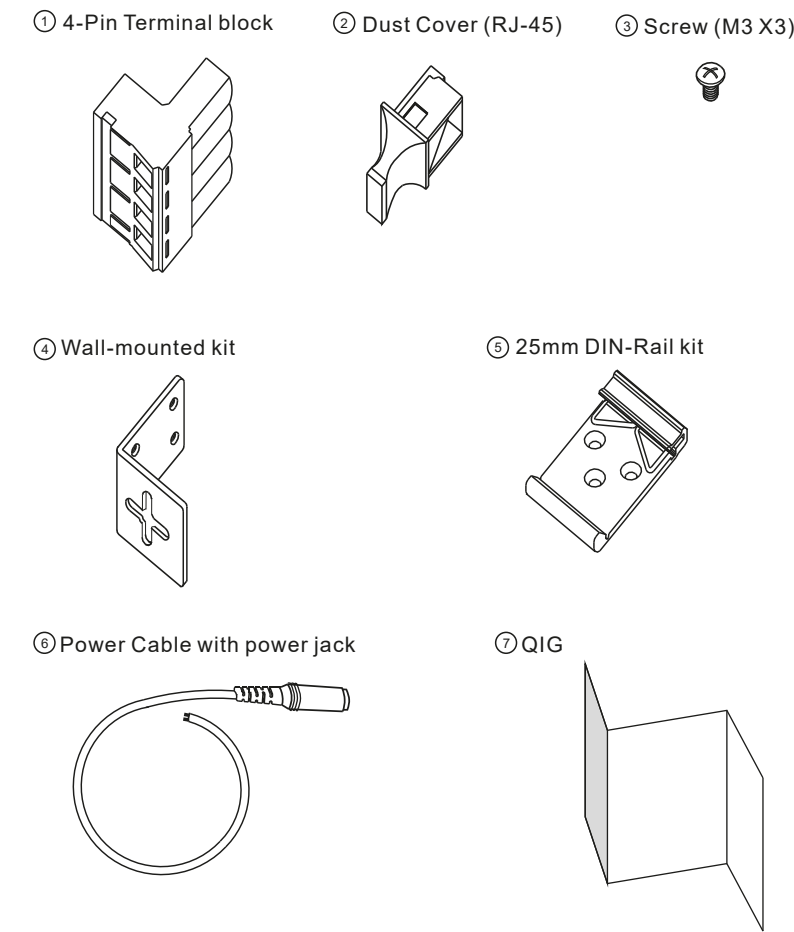

Communication Connections

10/100Base-T(X) Ethernet Port Connection

RJ45 (8-pin, MDI) Port Pinouts RJ45 (8-pin, MDI-X) Port Pinouts

Pin	Single		Pin	Single	
1	Tx+		1	Rx+	
2	Tx-		2	Rx-	
3	Rx+		3	Tx+	
6	Rx-		6	Tx-	

RJ45 (8-pin) to RJ45 (8-Pin) Straight-Through Cable Wiring

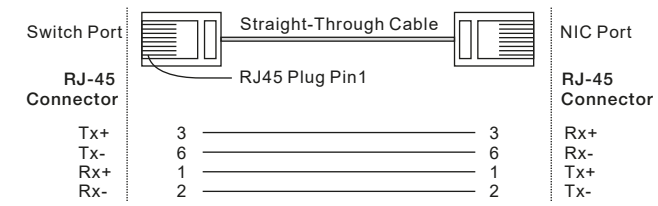

RJ45 (8-pin) to RJ45 (8-Pin) Cross-Over Cable Wiring

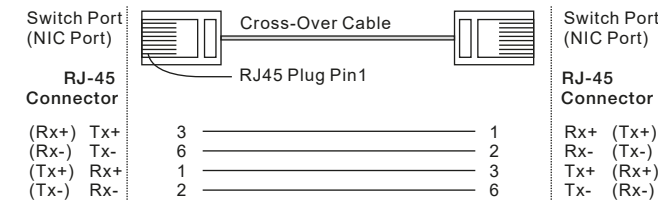

100Base-FX Connection

