

**CHUANGO®**  
*Safe Home. Easy Security.*

# OV6

WiFi Alarm System



# Features

- Easy setup in minutes — without specialized tools or professional installers
- Real-time alerts on your smartphone when any detector is triggered
- Quick customizations for any residential/housing type
- Convenient control of the system and other smart devices in the Tuya “Smart Life” app
- Smart home automations or schedules of multiple smart devices in the app
- Direct compatibility with Amazon® Alexa and the Google® Assistant to arm, disarm, home arm the alarm system, just with your voice
- Intuitive sharing devices among family members

# As Easy As 123

Who knew security could be this sexy? With no wires and no fuss, the OV6 is a smart system that will grow on you and grow with you. From door/window contacts and PIR motion sensors to flood, gas and smoke detectors, everything is wireless and will go wherever you want them to with 3M tapes, turning your security reinforcement into a fun DIY project.



1



2



3

# Real-time Notification

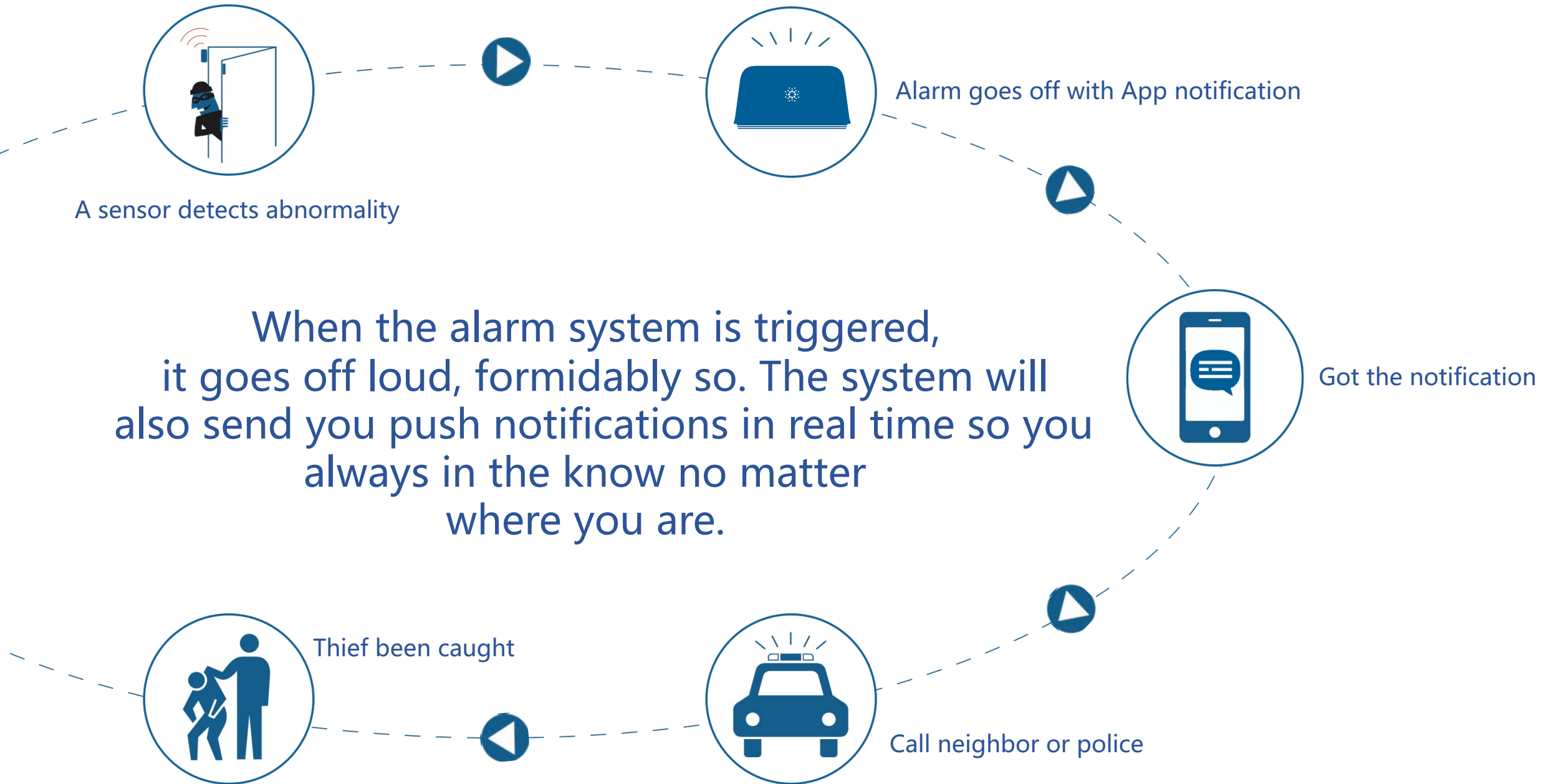



# Smart Hub

- App control and setting from anywhere
  - Sends push notifications when sensor is triggered in real time
  - Operation and event log
  - Built-in loud siren and backup batteries
  - Guards your sweet home 24/7
  - Add accessories according to your need
- 

## SPECIFICATIONS

Power: DC 12V 500mA

Backup battery: AA 1.5V LR6 battery x 4pcs

Frequency: 315MHz or 433.92MHz

Wi-Fi: 802.11b/g/n with WEP/WPA/WPA2 encryption 2.4GHz

Operating conditions: temperature 0-50°C,

humidity < 90% RH (non-condensing)

Dimensions (L x W x H): 87.5 x 81.5 x 12 mm



# Smart Home Security

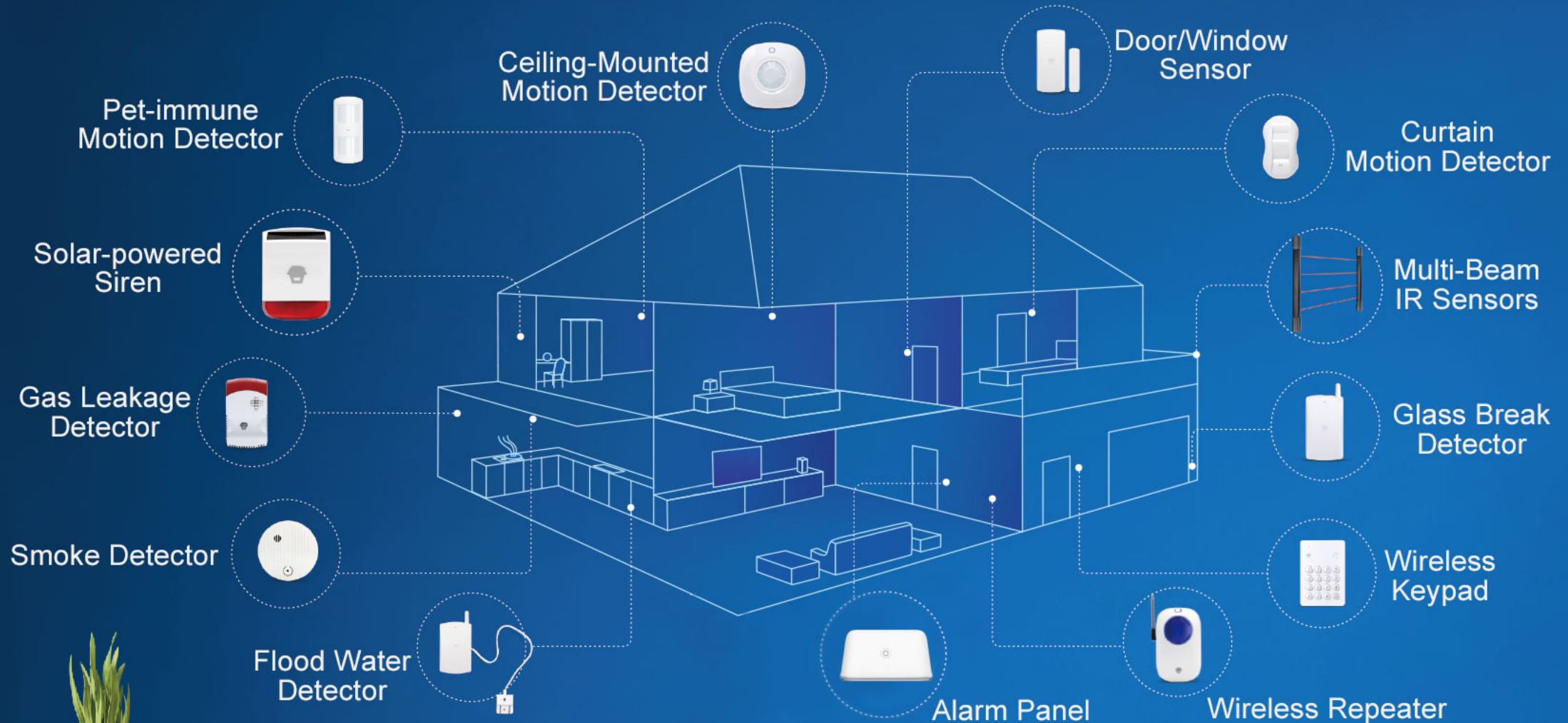

# App Control

Search “Smart Life” in App Store or Google Play

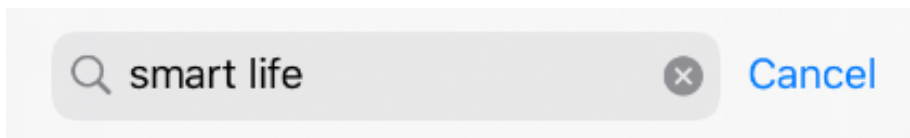

Smart Life - Smart...

Lifestyle

★★★★★ 1.8K

OPEN

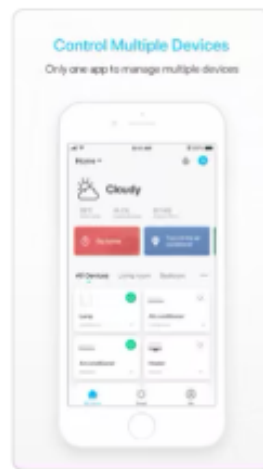
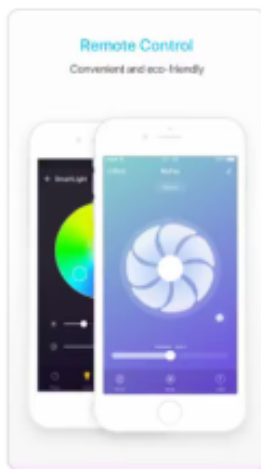
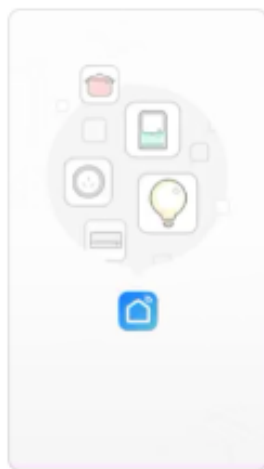

Powered by



Intelligence  
Inside

# Easy Control

- Arm, Disarm, Home Arm and trigger alarm
- Add multiple systems for different locations, for example: home and office

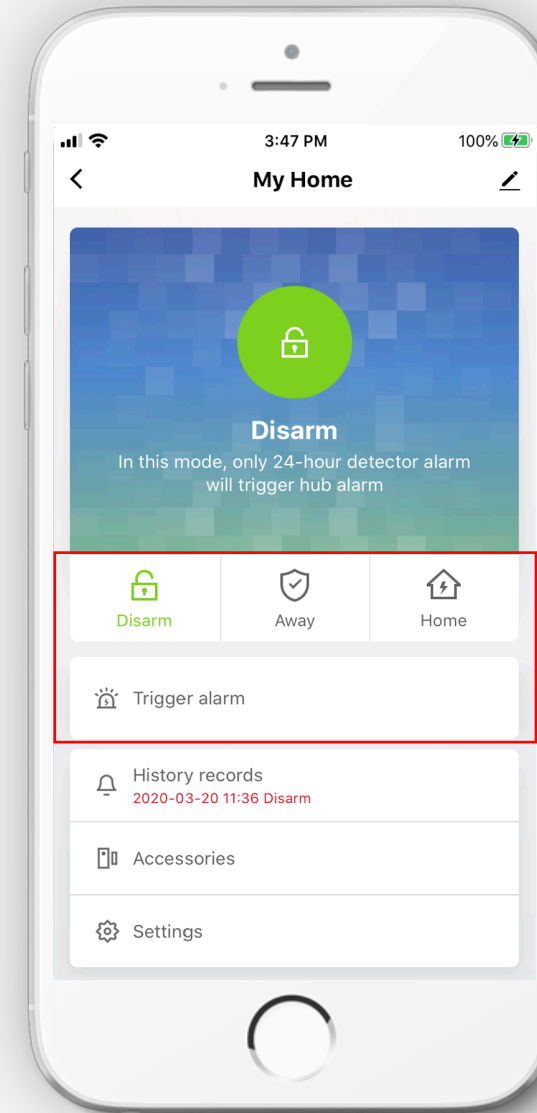
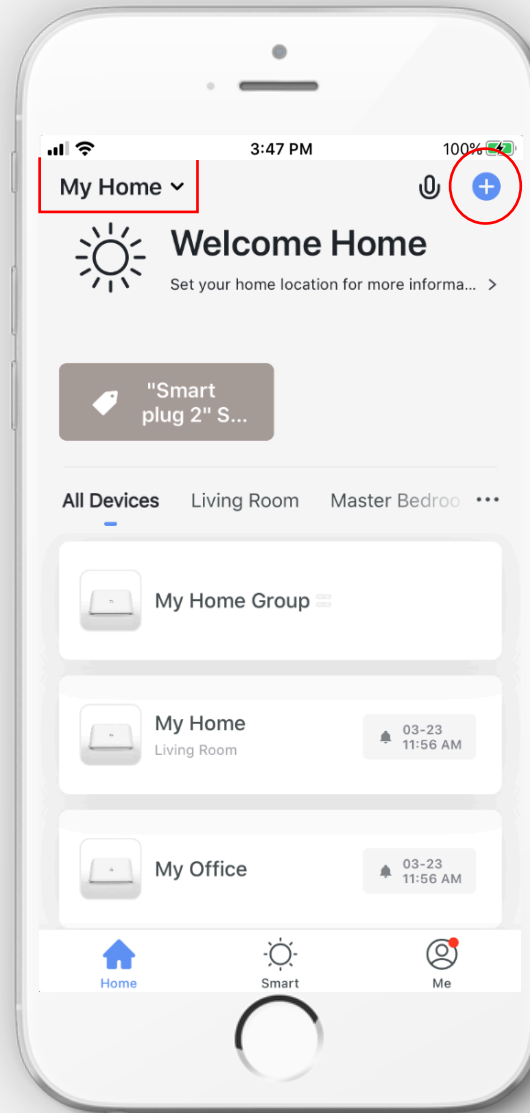

# History Records

- All operation (Arm, Disarm, Home Arm) and alarm events will display in History Records

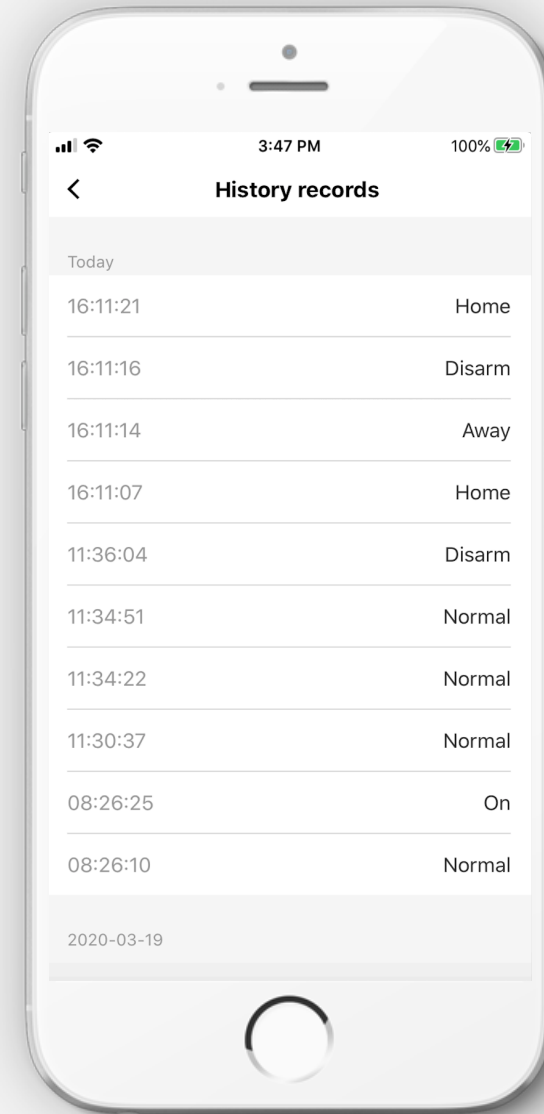
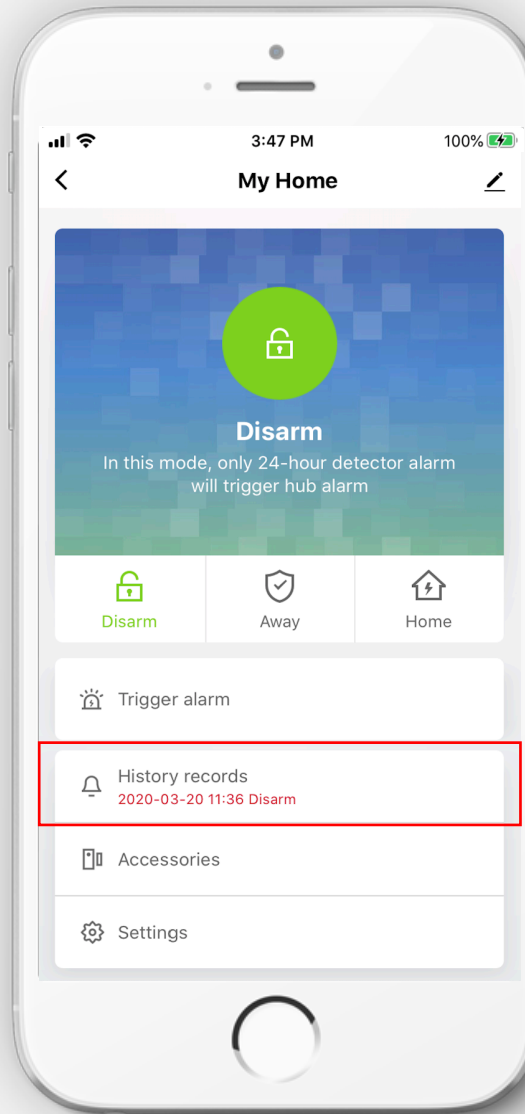

# Accessories

- The OV6 system supports 50 detectors (including motion, door/window, water, smoke, gas, vibration etc.) and 10 remote controllers

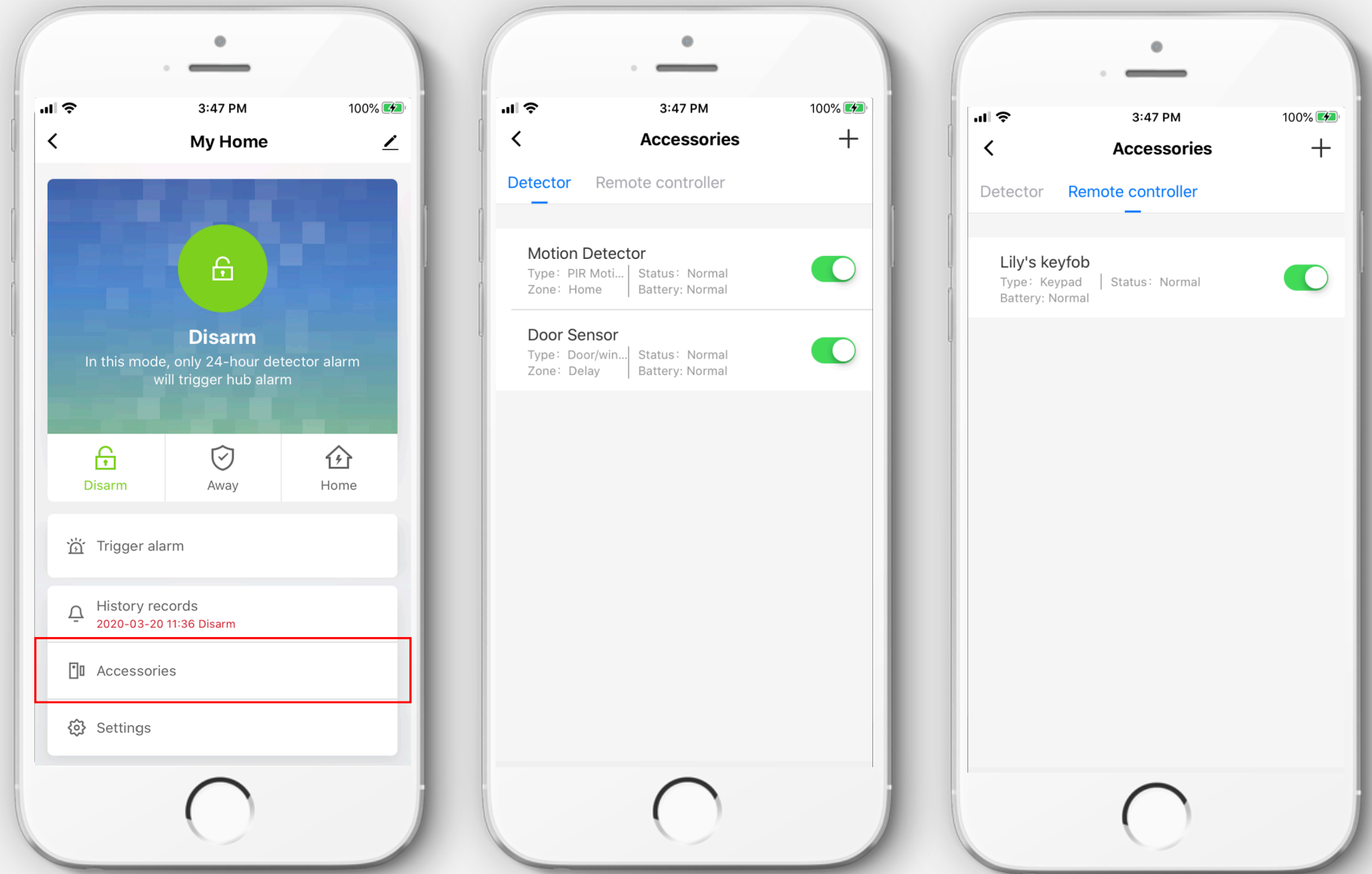



# Hub Settings

- Delay setting (the system arms after this time)
- Timer (Set up schedules for automatic arm, disarm and home mode)
- Delay alarm time (the system alarms after this time---only when the sensor in Delay Zone Mode is triggered)

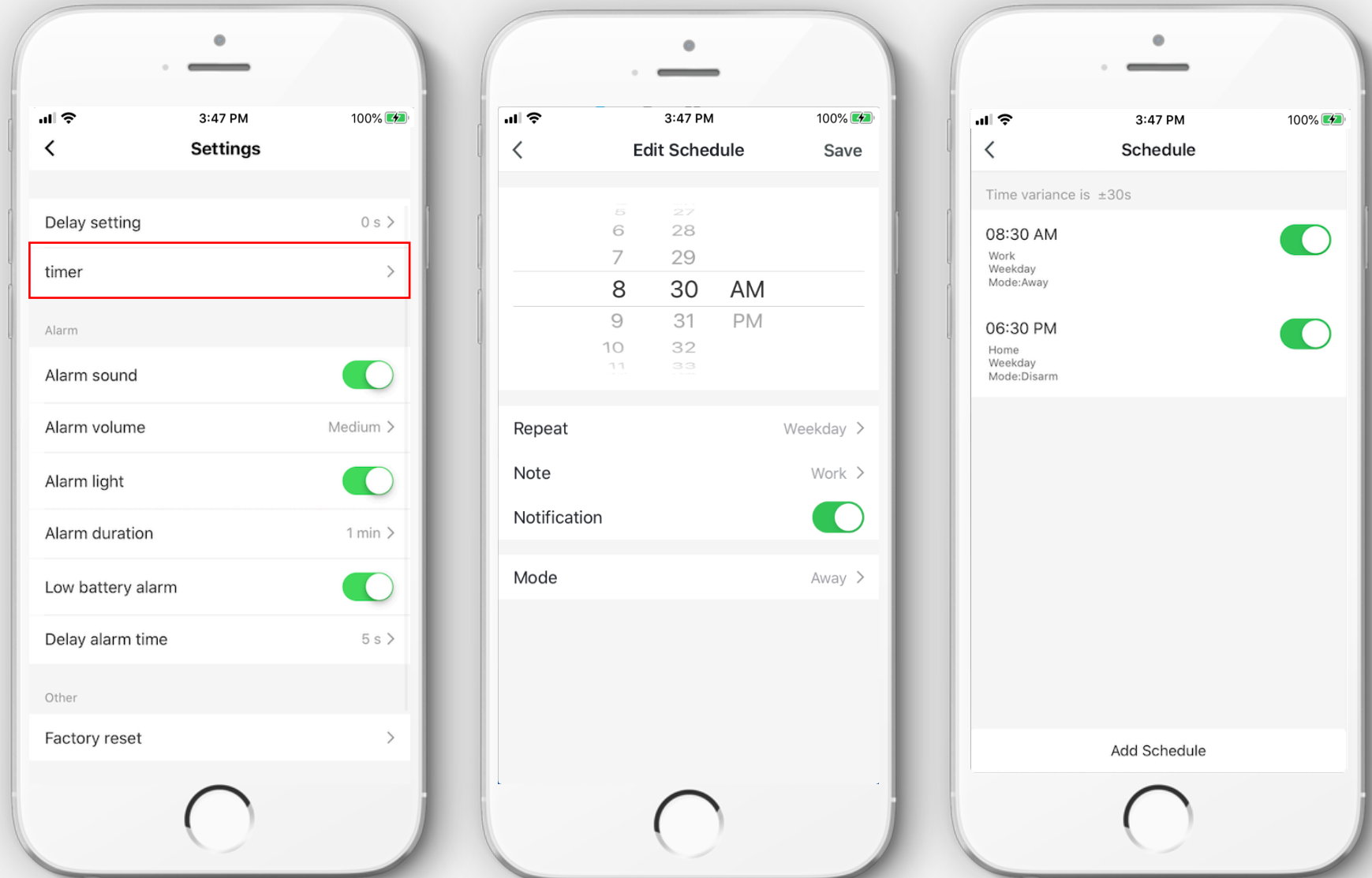

# Other Settings

- Edit the device name
- Check device info.
- Set Tap-to-Run and automation
- Third-party control
- Turn on/off device offline notification
- Share device
- Create group for quick group control
- FAQ & feedback
- Check device network
- Check for firmware update
- Remove device
- Restore factory defaults

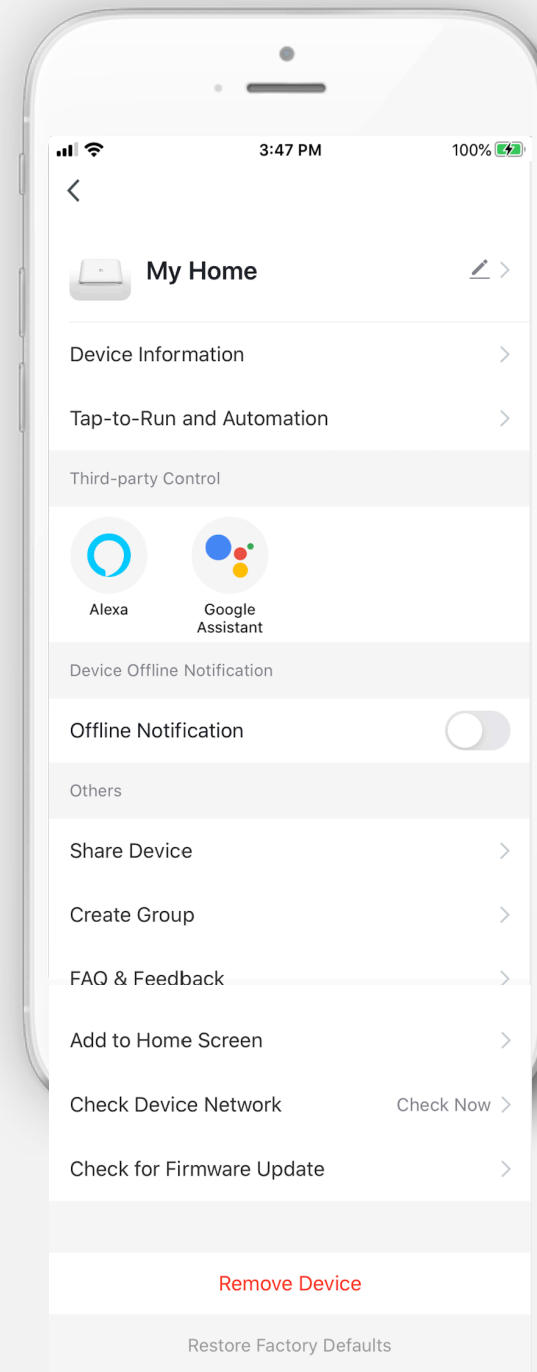
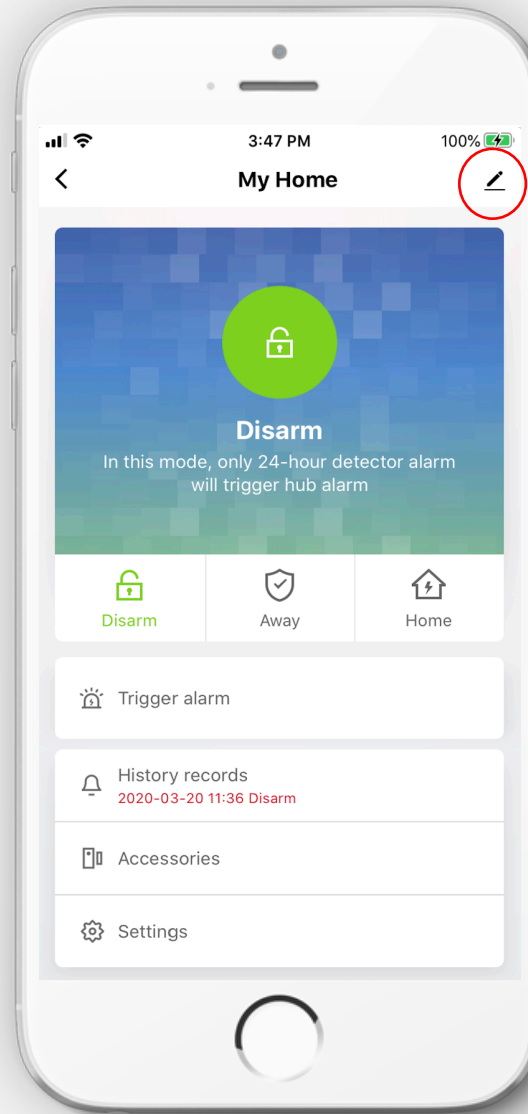

# Tap-to-Run

## Steps:

1. Launch Tap-to-Run
2. Choose device(s) and set up the task
3. Tap the button, then all devices will execute the task at the same time

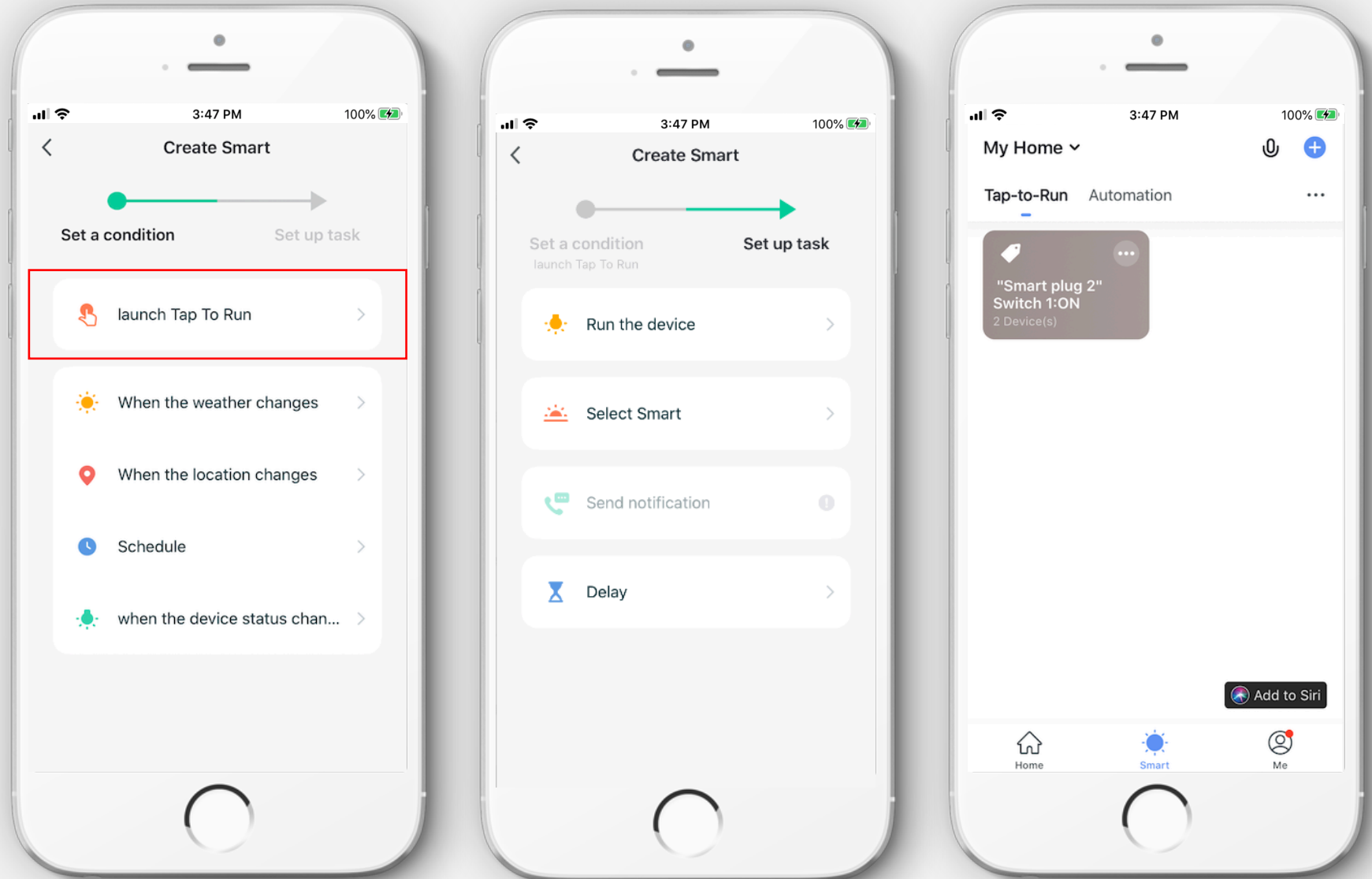

# Automation

## Steps:

1. Set your condition
2. Choose device(s) and set up the task
3. Enable the automation

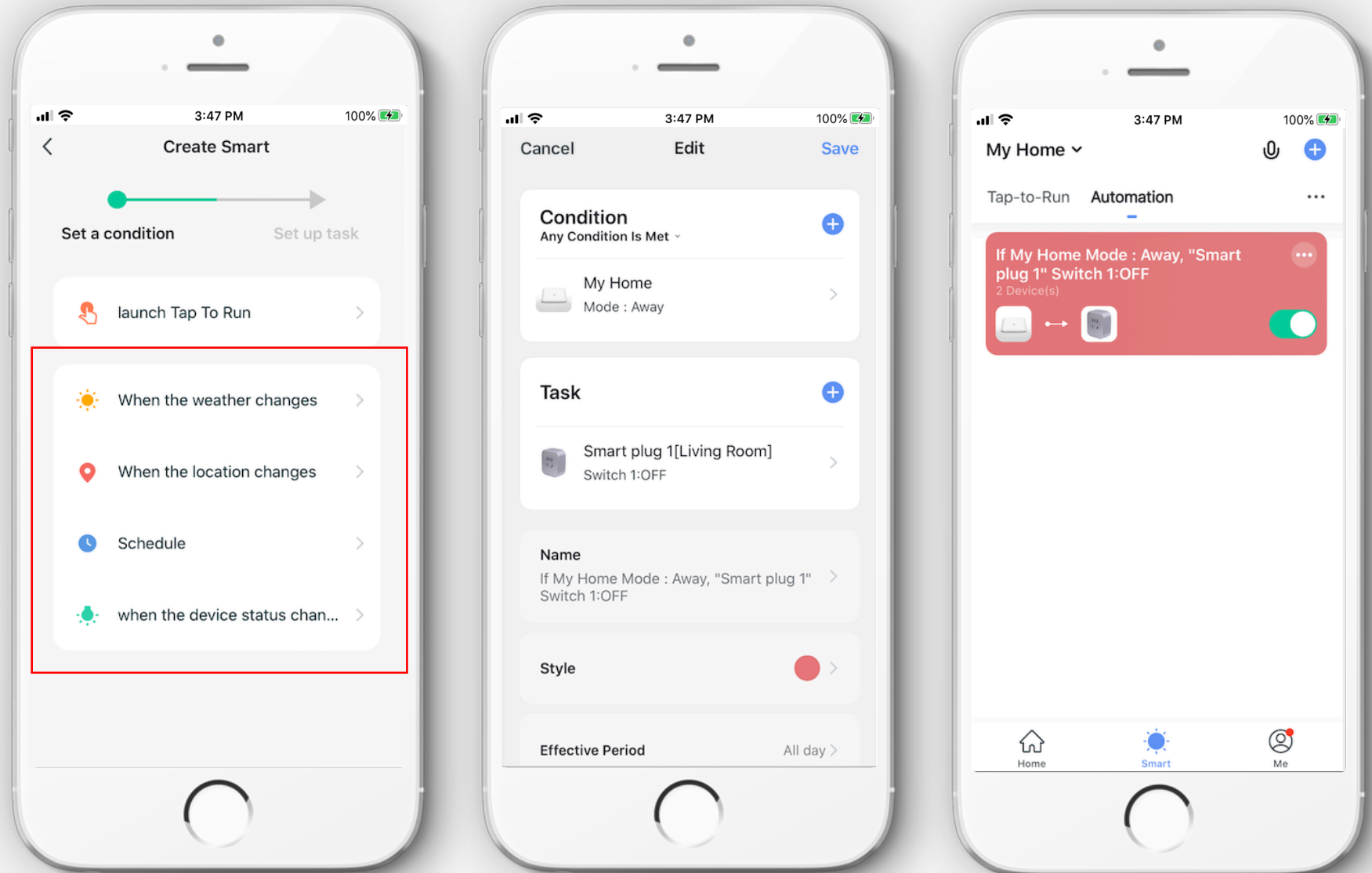

# Third-party Control

- You can Arm, Disarm, and Home Arm the OV6 system with Amazon Alexa and Google Assistant
- A voice code is required for disarming the system (set the code in Alexa and Google Assistant's app)

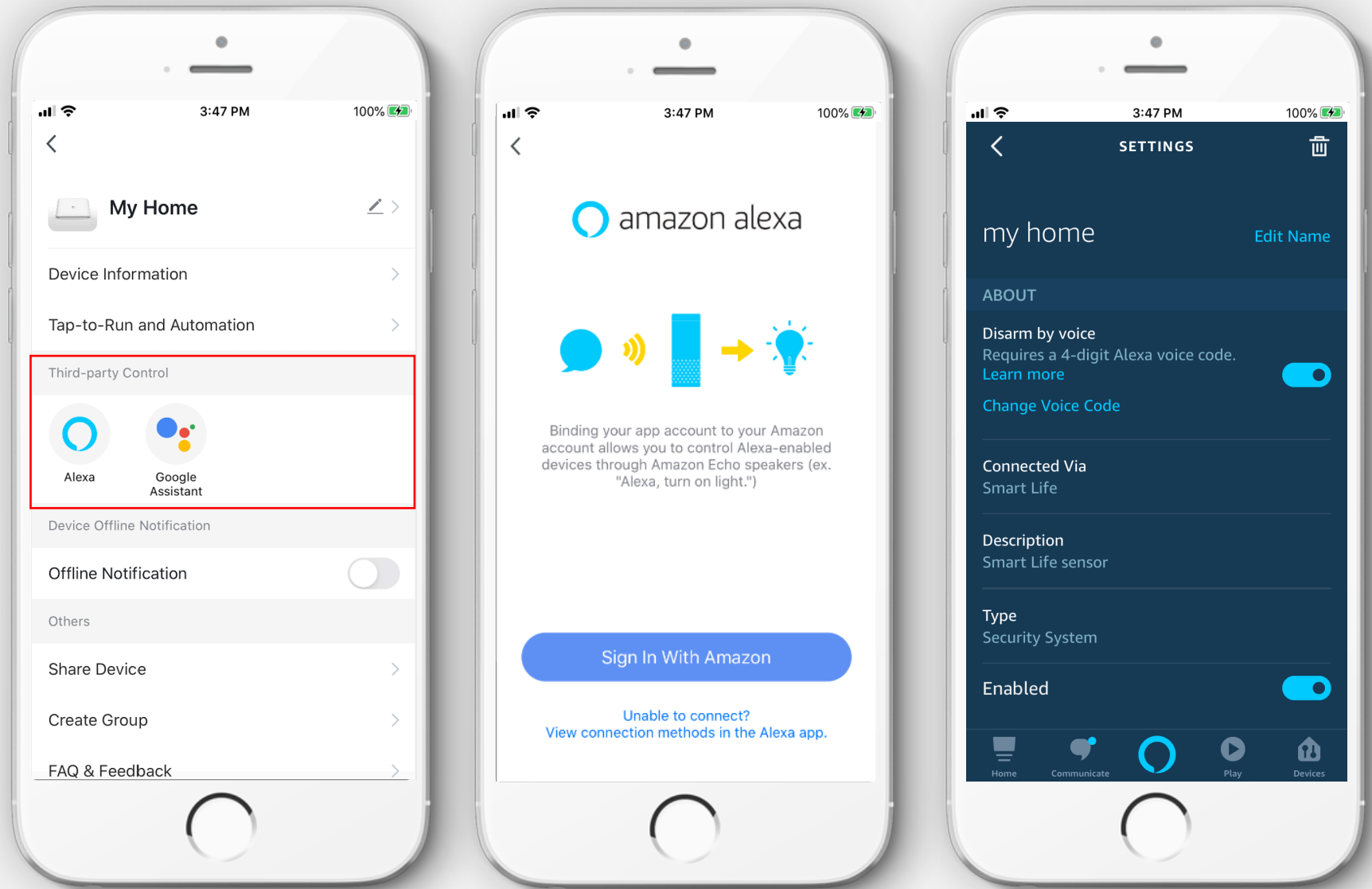

## Voice commands:

- Arm: Alexa / Hi Google, arm [device name] in away mode.  
Home Arm: Alexa / Hi Google, arm [device name] in home mode.  
Disarm: Alexa / Hi Google, disarm [device name] with [voice code].

# Share Device

- There are two ways to share the device:
- 1. Share individual device (to another account)
- 2. Share all devices (to family members) with the option of authority (Administrator or common member)

1

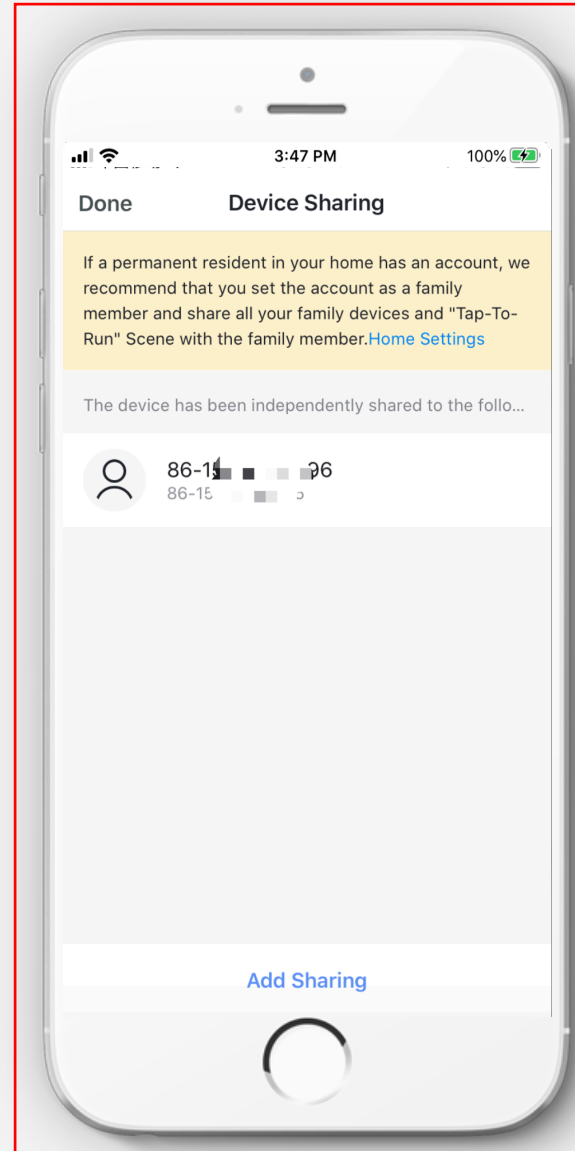

2

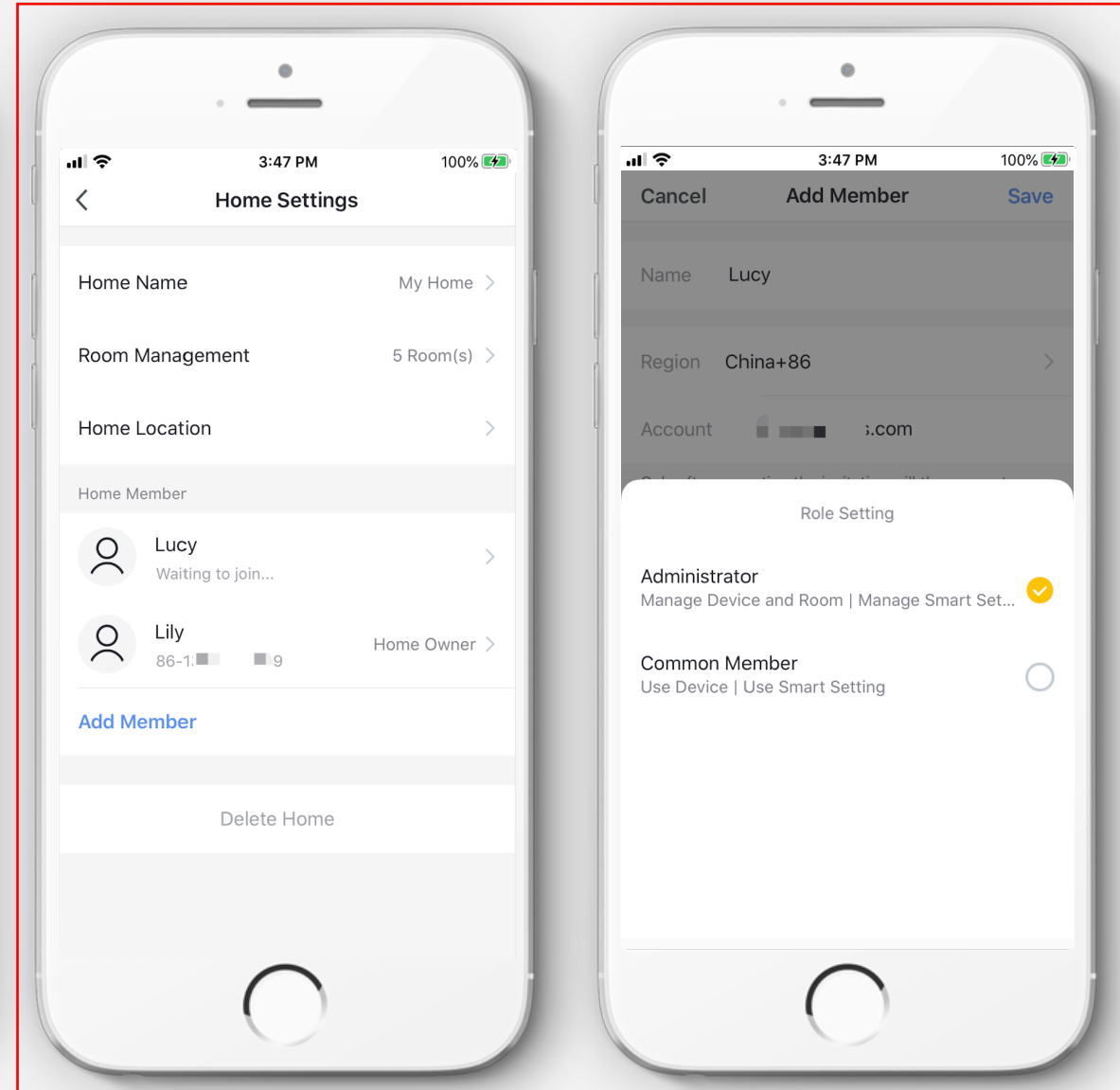



# Group Control

## Steps:

1. Create group
2. Choose device(s) and set up the task
3. Enter the group, then you can control all devices at the same time

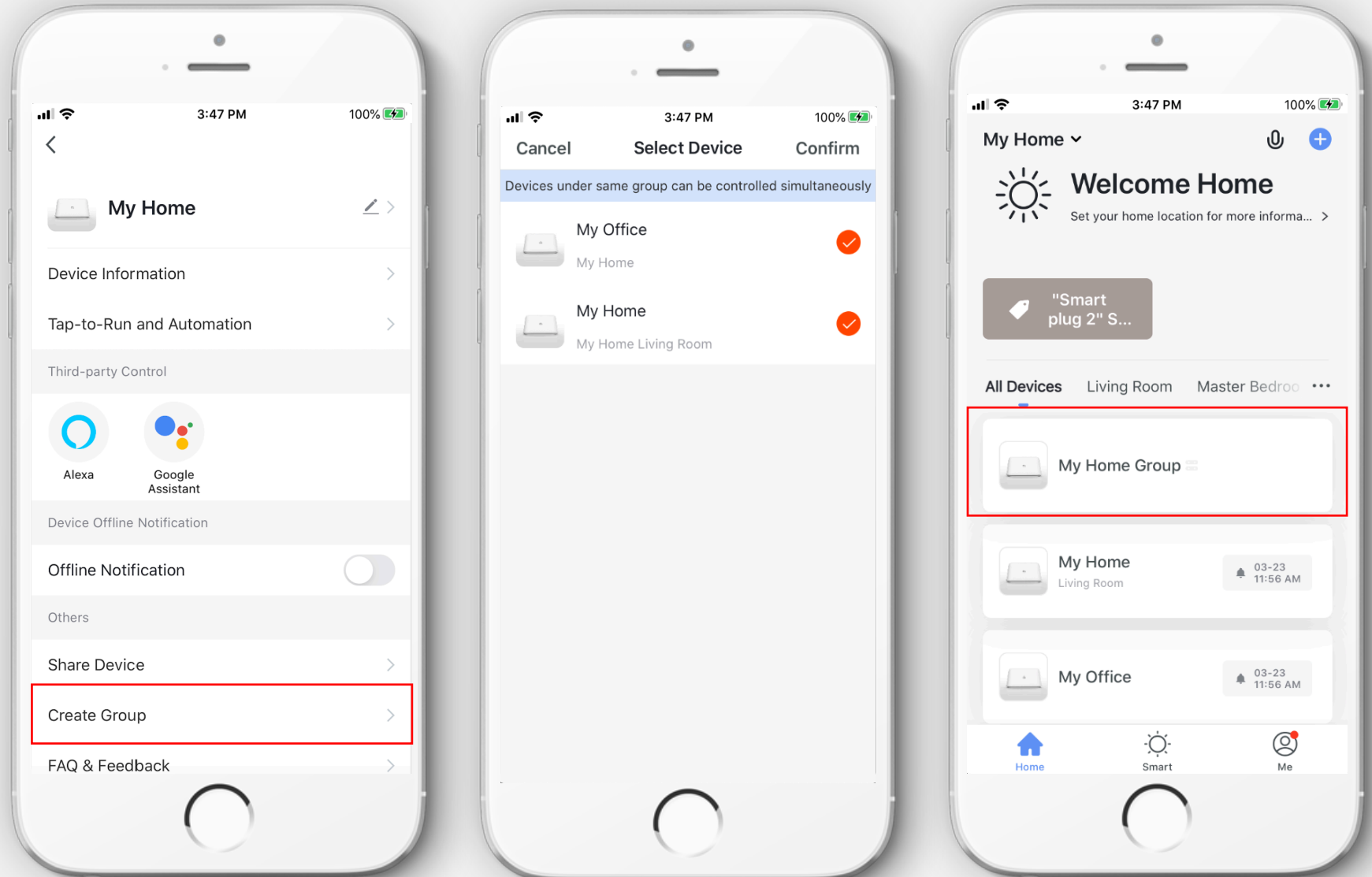

# Message Center

- You can check all alarm events, home related messages, and Bulletins in [Me] – [Message Center]
- You can turn off the notifications all or separately in Notification Settings

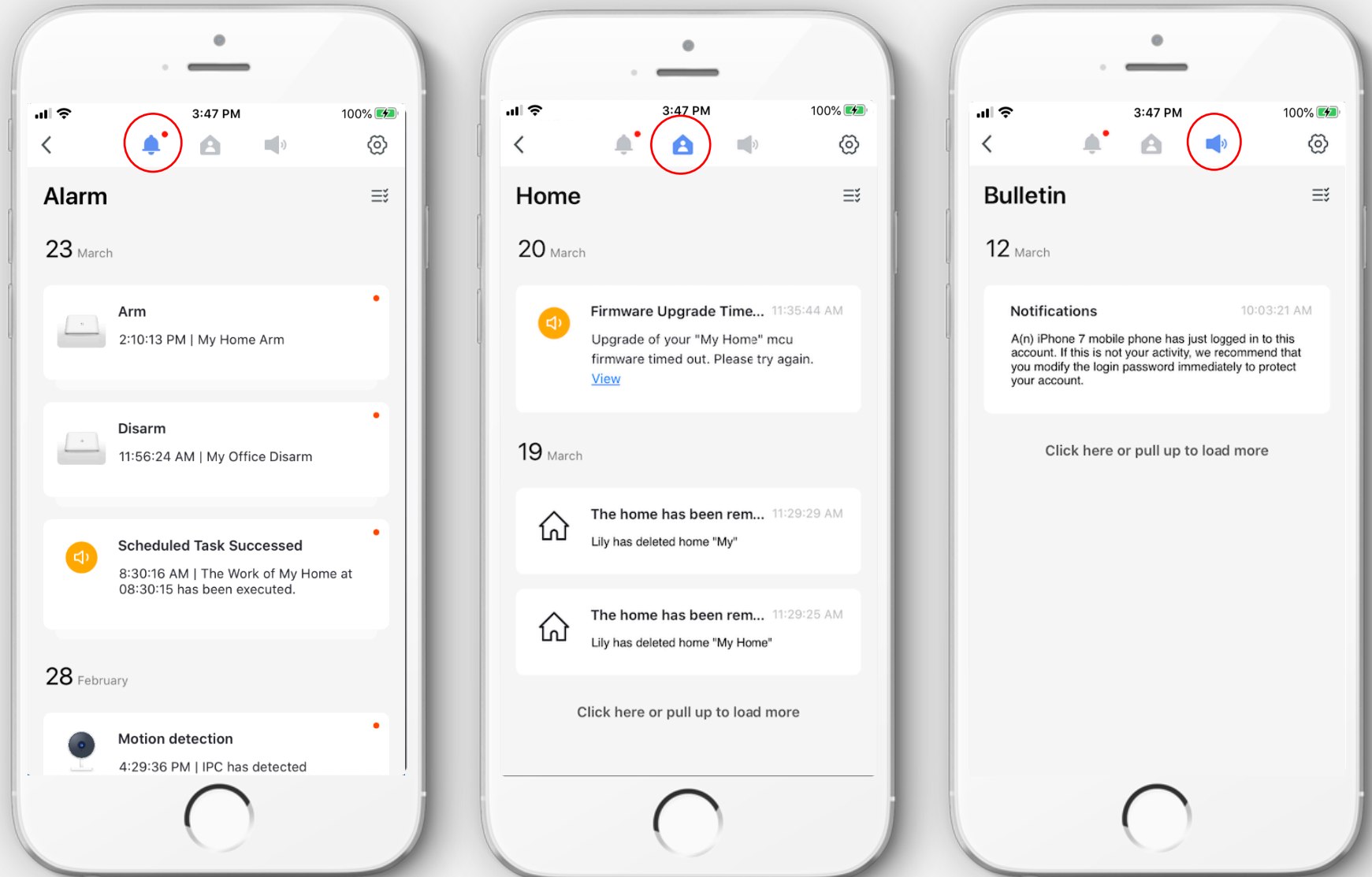

# Notification Settings

- Notification sound on/off
- App notification settings
- Do-Not-Disturb schedule

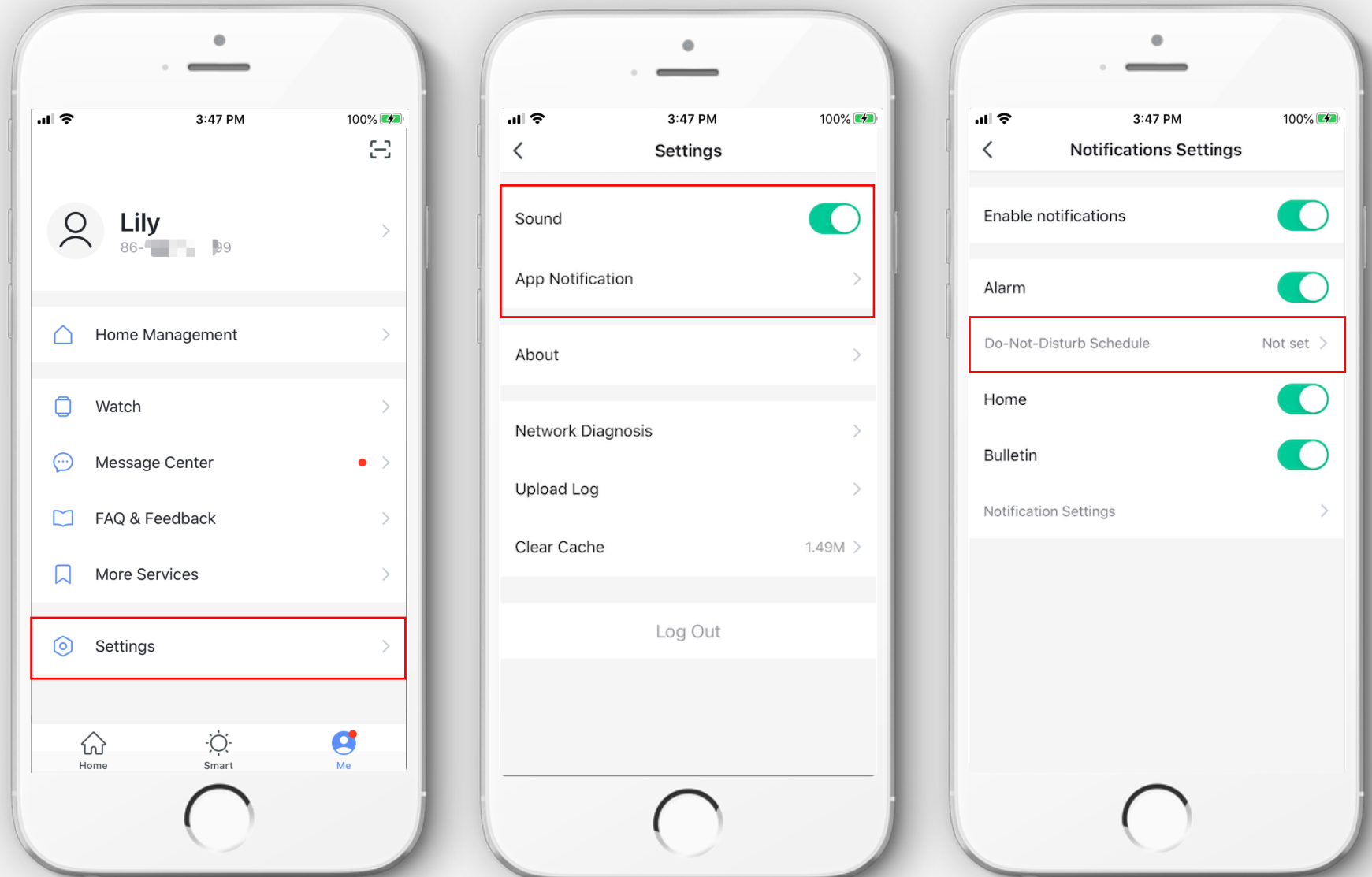

# Outer Packing Design



# Packing List



## **OV6 Smart Hub x 1**

- The Hub is the heart of the system that receives, processes and sends signals from & to the wireless.



## **DWC-102 Door / Window Contact x 1**

- As a best guardian of a door & window, the Sensor monitors your door & window for 24H.



## **RC-80 Remote Control x 1**

- The remote control makes it easy to Arm, Disarm, Home Arm the whole system.



## **Warning Stickers x 2**

- Warn and notify others to leave the alert zone without permission

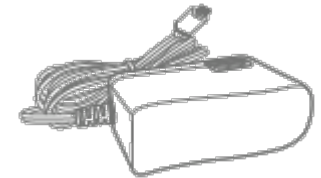

## **AC Adapter x 1**

# Door/Window Contact

Detects openings on doors or windows  
Easy to install with 3M double-sided adhesive tape  
Battery life up to 20 months  
Tempering alarm

---

## SPECIFICATIONS

Model: DWC-102

1.5V AA LR6 battery x 1 pc

Frequency: 315MHz or 433.92MHz

Operating conditions: temperature 0-50°C,  
humidity < 90% RH (non-condensing)

Transmitter dimensions (L x W x H): 71 x 34 x 17.5 mm

Magnet dimensions (L x W x H): 51 x 12 x 13.5 mm







# Remote Control

Easy to carry

Arm/Disarm/Home mode/Panic button

Battery life up to 5 years

---

## SPECIFICATIONS

Model: RC-80

Power: DC 3V (CR2025 Lithium Battery x 1pc)

Frequency: 315MHz or 433.92MHz

Operating conditions: temperature 0-50°C,  
humidity < 90% RH (non-condensing)

Dimensions (L x W x H): 58 x 31 x 9.5mm

# Optional Sensors & Accessories

## PIR Motion Detectors



Pet-Immune PIR  
Motion Detector  
PIR-910



Curtain PIR  
Motion detector  
PIR-800



Ceiling-Mounted PIR  
Motion Detector  
PIR-700



Solar-Powered PIR &  
Microwave Motion Detector  
PIR-926

## Door/Window Contact



Roller Shutter Door Sensor  
DWC-55



Metallic Door/Window Sensor  
DWC-3F

# Optional Sensors & Accessories

## Environmental Detectors



**Water Sensor**  
WI-210



**Smoke Detector**  
SMK-500



**Glass Break Detector**  
GT-126



**Vibration Detector**  
WD-80



**Gas Detector**  
GAS-88

## Sirens



**Solar-Powered Siren**  
SPS-260



**Outdoor Strobe Siren**  
WS-280



**Dummy Siren**  
DPS-26



**Wireless Strobe Siren**  
OSR-10



**Indoor Mini Strobe Siren**  
WS-105

# Optional Sensors & Accessories

## Remote Controllers



**RFID Wireless Keypad**  
KP-700



**Panic Button**  
SOS-100



**RFID Tag**  
TAG-26  
Works with KP-700

## Others



**Wireless Signal Repeater**  
RT-101



**Multi-Beam IR Sensors**  
AID-420

# Questions?

