



MARKING:
 THE MARKING OF THE CORDS:
 ◁ VDE ▷ H05VV-F 3×1.0mm²

THE MARKING OF THE PLUG:
 YDL-10 10A 250V~ YUXIN 

THE MARKING OF THE CONNECTOR:
 XT3 10A 250V~ C13 

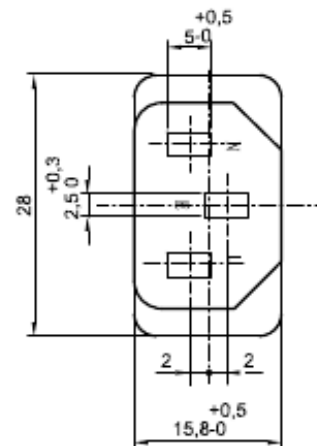
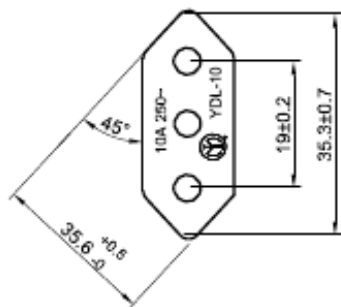

DIMENSIONS AND CHARACTERISTICS OF 1.0mm² CORD
 RATED VOLTAGE 300/500V
 NUMBER OF CORE 3
 CONDUCTONS
 CONSTRUCTION 32/0.2

3	1	XT3 IEC60320 C13
2	1	Cable H05VV-F 3×1.0mm (BLACK)
1	1	YDL-10(Italy PLUG)